

EuroFit Cascade Shelf Merchandiser

Product Parts

- 1 - Side Poles (x6)
- 2 - Top Curved Corners (x2)
- 3 - Feet (x2)
- 4 - Hex Bolts (x6)
- 5 - Washers (x6)
- 6 - #4 Hex Wrench for TV Mount
- 7 - #5 Hex Wrench for Frame Bolts
- 8 - Top Horizontal Pole
- 9 - Shelf+ (x2)
- 10 - Miscellaneous Mounting Hardware*
- 11 - Mounting Bracket
- 12 - Case

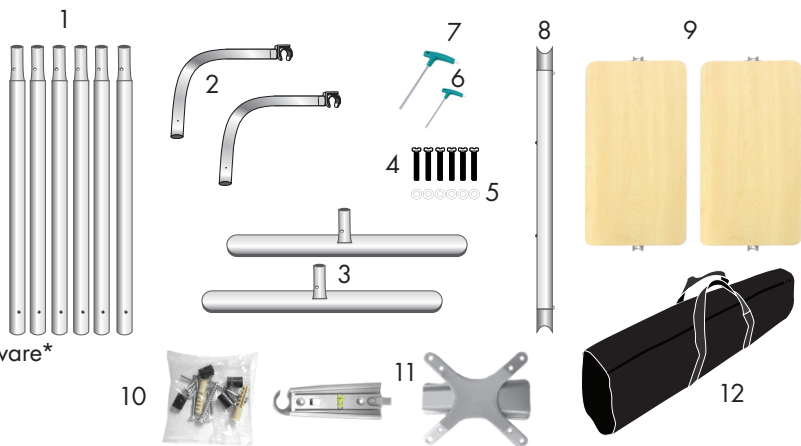

*Use only the machine screws to secure monitor to Mounting Bracket.

+ Shelf recommended for max 5lbs.

Display Set-Up

Step 1

Assemble hardware laying it on a flat clean surface. Do not attempt to stand or attach the hardware vertically until fully assembled. All parts are numbered for easy assembly.

Step 3

Using the Hex Bolts (4) and Washers (5) attach the bottom Shelf+ (9) to the frame. Hand tighten only.

Step 4

Using the Hex Bolts (4) and Washers (5) attach the top Shelf+ (9) to the frame. Hand tighten only.

Step 5

Using the Hex Bolts (4) and Washers (5) attach the Top Horizontal Pole (8) to the frame, making sure the bolts are facing towards the front. Hand tighten only.

Step 6

Using supplied #5 Hex Wrench (7) tighten all Hex Bolts (4).

Step 2

Fully assemble the left Side Poles (1), Feet (3), and Top Curved Corners (2). Match numbers marked on hardware. Repeat for the right side.

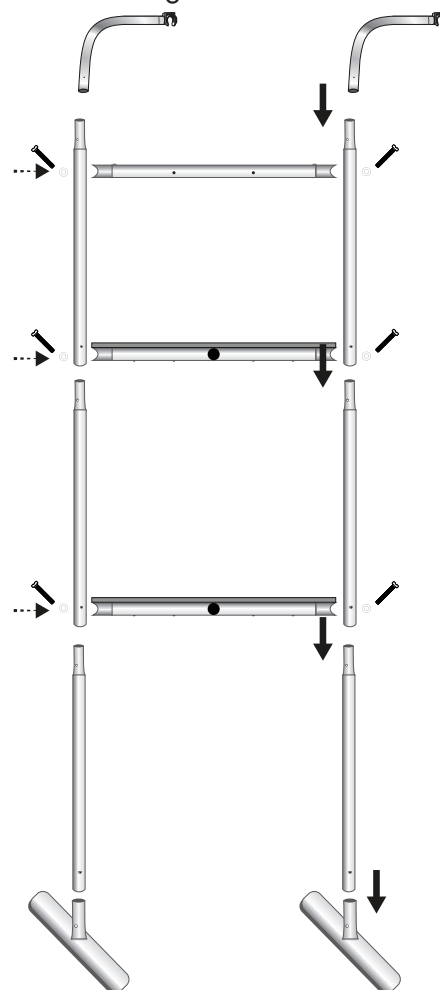

Display Set-Up Continued ...

Step 7

Unscrew bolts from Top Horizontal Pole (8A) using supplied #4 Hex Wrench (6) for Mounting Bracket (11).



Step 8

Mount bottom half of Mounting Bracket (11) to Top Horizontal Pole (8B) with bolts just removed.

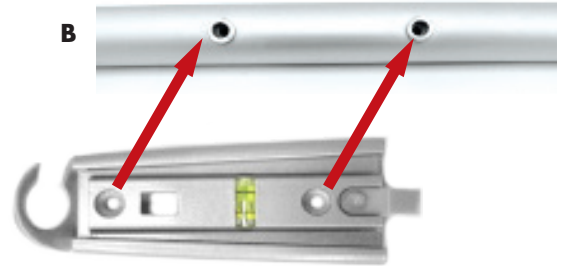

Step 9

Slide top half of Mounting Bracket (11C) into bottom half of Mounting Bracket (11C). The tab will click when locked.

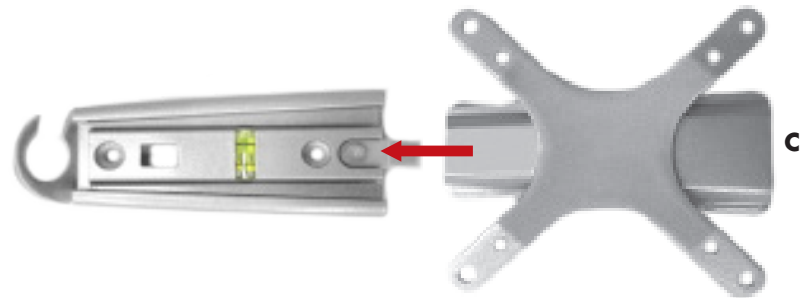

Mounting TV

We recommend using a TV no larger than 23". Please follow TV/Monitor manufactures recommendation for final mounting. Top half of Mounting Bracket will attach to back of most TV/Monitors.

Illustration is for reference only.

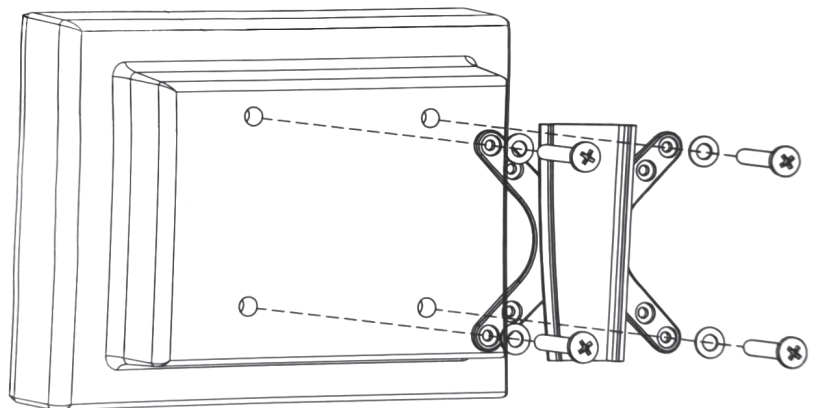

Storage and Care

Place all product parts into carry case and store in a cool dry location. To clean, wipe with damp cloth.